

The 31 day of August 1808, by Jerry May D^y
Thomas Berry & Uenow Standron (C^l)
Examined and correctly ascertained (W. J. Proctor)
Transmitted to the Register 6th Feb^y 1809.

Returned 1st
Sept 1808



Scale of 100 p^o p^o Inch

At the request and upon the application of William Martin I have surveyed for him 100 acres of land in Bedford County 2^d District and on the Garrison fork of Duck River immediately below the mouth of Noahs fork of the same Beginning at a large Buck on the south bank of said fork marked EA running from thence North 70 poles to a Red Elm & thence East 100 poles to a Sugar tree & thence South crossing said fork at low poles in all 100 poles to a Redwood and arch thence West 100 poles to a Sugar tree & thence North 90 poles to the beginning including said William Martins improvement August 22^d 1808

N^o 1020

Abner Bright & John Drake D^y 2^d
Joshua Apley & C^l
Examined and correctly ascertained

Returned 1st
Sept 1808



Scale of 200 p^o p^o Inch

State of Tennessee 2^d District
at the request and upon the

N^o 1021

application of Robert Hairston I have surveyed for him 300 acres of land which is situated in the County of Bedford on the south side of Elk River and both sides of Gregg Creek and is bounded as follows (to wit) Beginning at a white oak John Edmestons south east corner of his 640 acre survey running thence west with said Edmestons line crossing Gregg Creek at 66 poles in all 220 poles to a black oak thence South 213¹/₂ poles to a white oak thence East 220 poles to an Elm on the west boundary line of a 124¹/₂ acre tract and 18 poles land off for the use of schools in the 3^d Range & 1st Section thence North with the same 213¹/₂ poles to the beginning which is truly represented in the annexed plat and was surveyed the 15th day of August 1808 by
Drury Abbot & Andrew Edmeston (C^l) James Bright D. S.

Returned 1st
Sept 1808

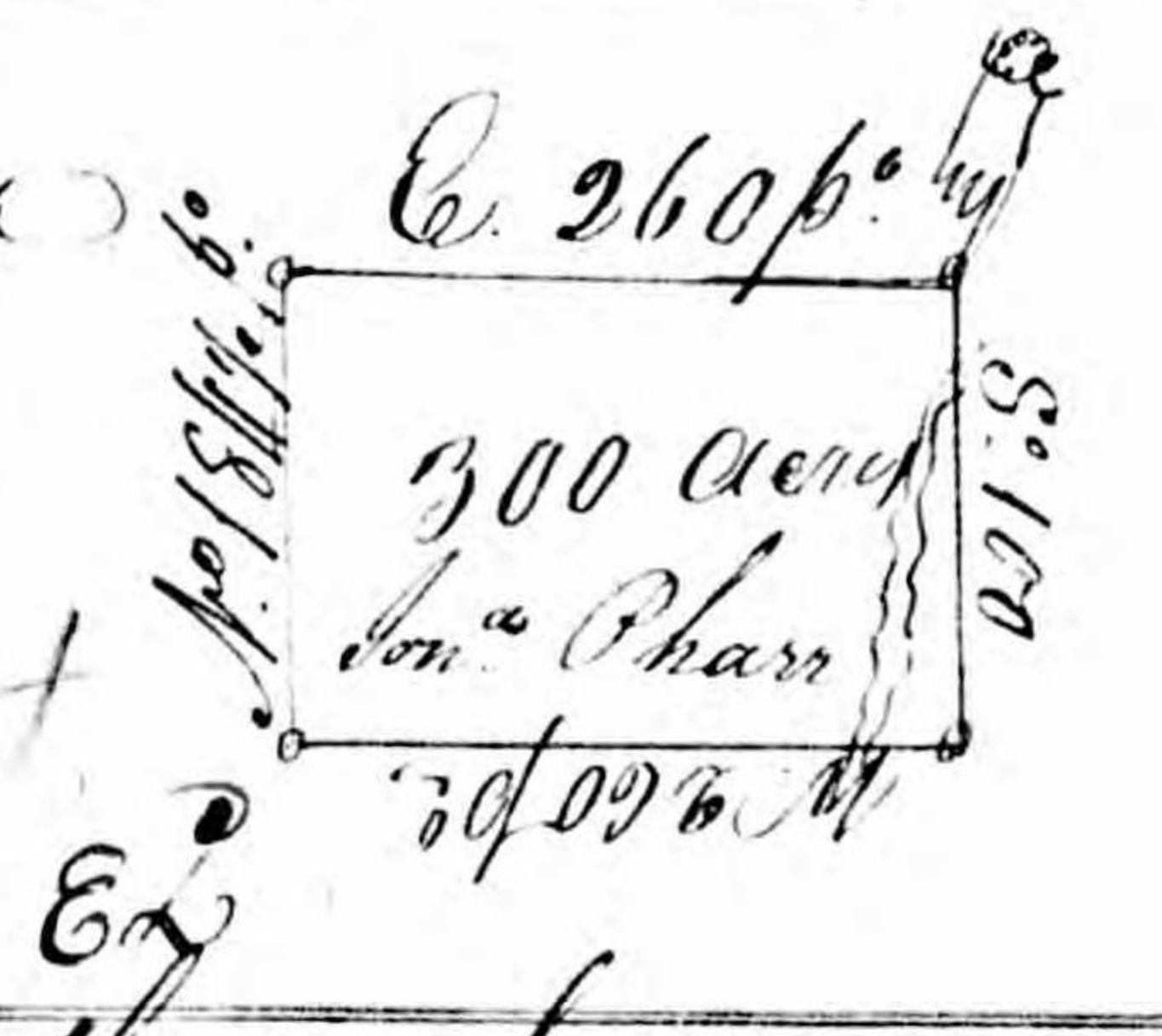

Scale of 200 p^o p^o Inch

N^o 1022

Upon the application of Jonathan Pharr I have surveyed for him three hundred acres of land situated lying and being in the County of Bedford in the Second District and on the middle fork of Duck River including his improvement Beginning at a large Buck standing on the North East bank of the middle fork of Duck River a small distance below where said Pharr and Joseph Walker are building a mill running from thence South 100 poles to two white

Robert Hairston Marker
Examined and correctly ascertained