

July 24th 1784

Surveyed for William Hays
agent of James Fortsh 1500 acres of Land
by virtue of a Certificate for Settlement
duly Entered February 3^d 1780 adjoining
said Hays agent of Jones On the East
Beginning at the N^o. E^t corner of his
Settlement at A, Large Walnut & Sugar tree thence East 260 poles,
Crossing a branch three times to B, two Sugar trees South 246 poles to C,
a Stake West 260 poles to D, a poplar and hickory corner to said Hays
agent of Jones North 246 poles with a line of the same to the Beginning

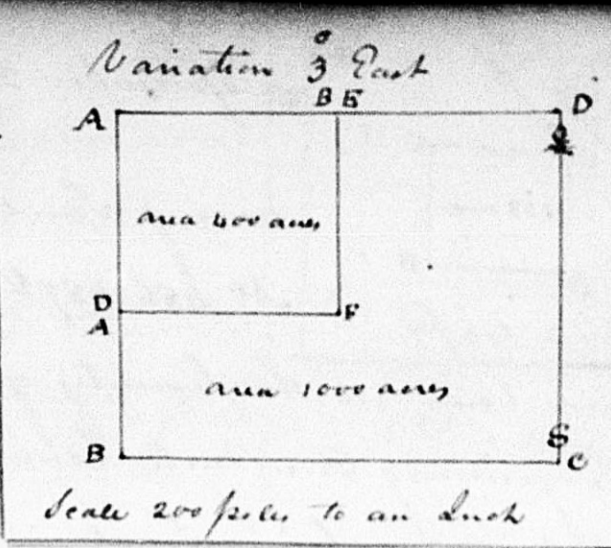

187.
delivered to
Wm Hays

Also One thousand acres by virtue of a Preemption Warrant
No. 1407 duly Entered December 11th 1782 lying and being in the
County of Fayette and on the South and East of the Settlement

Beginning at the S^o. W^o. corner of the Settlement at A, large poplar
& hickory thence South 185 poles crossing two branches to B, a double
Lynx thence East 520 poles crossing five small branches to C, two Oaks
North 431 poles to D, crossing a large branch and coming on two hickory
Saplings and a Walnut then West 260 poles to E, two Sugar trees South
246 poles to F, a stake West 260 poles with the Settlement line to the Beginning

William Brooks
Benjⁿ Maloy
Austin Samdage Marker

William Hays D^r. H^o.
W^o. Tho^s. Marshall S^r. C^o.

August 23^d 1784

Surveyed for James Shelby 50
acres of Land by virtue of a Military Warrant No. 141
duly Entered April 29th 1780 lying and being in Fayette
County betwixt the Kentucky & Hickmans Creek including
a sinking Spring where there is a tree or two marked JS, Beginning at A,
in Mountain line a Sugar tree thence S^o. E^o. East 126 poles to B, a hickory
and Sugar tree Sapling thence S^o. E^o. East 63 poles to C, a red Oak & Buckeye
N^o. E^o. West 126 poles to D, a Sugar & hickory in Mountain line thence with said
line S^o. E^o. West 63 poles to the Beginning

Scale 200 poles to an inch

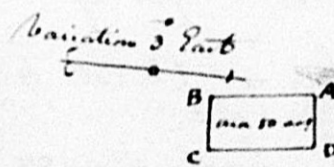

Delivered to
Abraham
Lincoln
for Brown

Septimus Davis
Samuel Mounts
Joseph Scholl Marker

William Hays D^r. H^o.
W^o. Tho^s. Marshall S^r. C^o.

Exam^d?