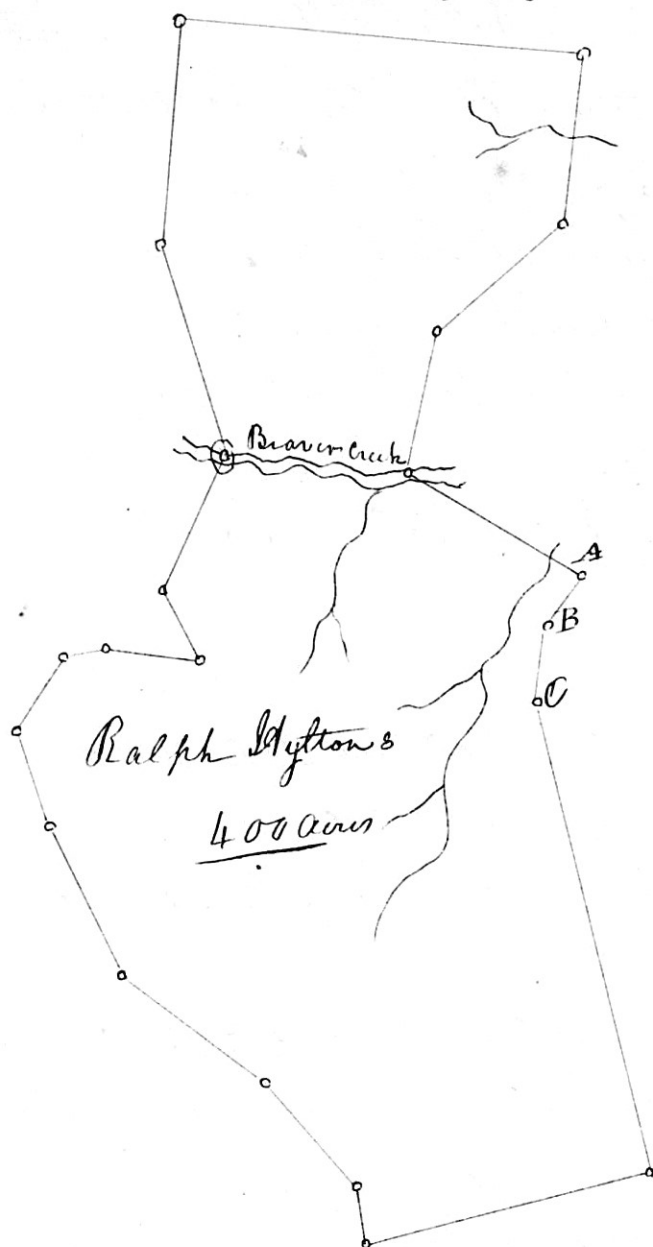

Feb. 4th 1779-

Surveyed for Ralph Hytton 400 Acres of Land situate in Bedford County on both sides of Beaver Creek and bounded as followeth. viz. Beginning at Flemings and Forbes's Corner Pointers on Flemings Line Thence along Fleming and Forbes's Lines S60 E. 24 poles to their Corner price E- 32 poles to their Corner price N 70 W. 200 poles to their and Andrew Hairstons Co. Pointers along Hairstons Line. S 20 E. 120 poles to his Corner Pointers on Land Hairstons Line Thence along Samuel Hairstons Lines - S 73 W 24 poles to his Corner Shrub white Oak S 40 W 54 poles to his Corner price S 30 W. 74 poles to his Corner price S 57 W. 68 poles to his Corner price S 65 W. 60 poles to his Corner price [price

N 62 W. 40 poles to his Corner price - N 25 W. 16 poles to his Co. N 40 poles to his Co price. S 60 W. 30 poles to his Co price N 74 W. 60 poles to his Corner in Beaver Creek at the old Mill place. S 65 W. 88 poles to his Corner price W- 88 poles to his and Hairstons Corner Victory along Hyttons Line N 2 W. 120 poles to Flemings Corner Pointers. Thence along Fleming Lines - E- 70 poles to his Corner price. S 46 E. 68 poles to his Co. price. S 83 E. 58 poles to his Co. price on Beaver Creek N 25 E. Crossing the Creek. 84 poles to the first Station
By Richd. Smith Surv^r

Feb. 8th 1779-

Surveyed for Peter Hairston 75 Acres of Land situate in Bedford County, on both sides, and including the head of Fishing Creek, being a west branch of the South Fork of Falling River and bounded as followeth viz. Beginning at Heaths Hairstons and Laner Co. price Thence along Laner Lines. N 60 E. 140 poles to his Co. Red Oak on Hairstons Line. Thence along Hairston Lines N 63 W.

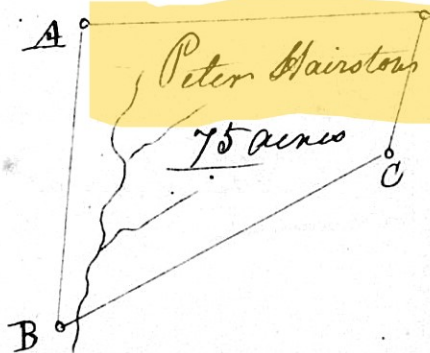

148 poles to his Corner black Oak near a path. S 70 W. 58 poles to his Corner Pointers S 36 E 140 poles to the first Station

By Richd. Smith Surv^r